

NOTES:
1. START AND END DATES OF PHASES SUBJECT TO CHANGE

KEY

1 HVM	PHASE 1 HVM - COMPLETE START DATE (ACTUAL): 5th JULY 2022 END DATE (ACTUAL): 19th AUG 2022
1A-1D	PHASE 1A TO 1D - COMPLETE START DATE (ACTUAL): 5th MAY 2022 END DATE (ACTUAL): 5th SEPT 2022
2	START DATE (ACTUAL): 15th JAN 2024 END DATE (INDICATIVE): 22nd MARCH 2024
3	PHASE 3 - COMPLETE START DATE (ACTUAL): 19th AUG 2022 END DATE (ACTUAL): 24th NOV 2022
4A	PHASE 4A - COMPLETE START DATE (ACTUAL): 19th AUG 2022 END DATE (ACTUAL): 14th FEB 2023
4B	PHASE 4B - COMPLETE START DATE (ACTUAL): 17th OCT 2022 END DATE (ACTUAL): 23rd FEB 2023
5A	PHASE 5A - COMPLETE START DATE (ACTUAL): 16th JAN 2023 END DATE (ACTUAL): 4th APRIL 2023
5B	PHASE 5B - COMPLETE START DATE (ACTUAL): 23rd FEB 2023 END DATE (ACTUAL): 1st JUNE 2023
6	PHASE 6 - COMPLETE START DATE (ACTUAL): 11th APRIL 2023 END DATE (ACTUAL): 5th MAY 2023
7 CON A	START DATE (ACTUAL): 03rd JAN 2024 END DATE (INDICATIVE): 02nd APRIL 2024
7 CON C	START DATE (ACTUAL): 03rd JAN 2024 END DATE (INDICATIVE): 16th APRIL 2024
8	PHASE 8 - COMPLETE START DATE (ACTUAL): 9th MAY 2023 END DATE (ACTUAL): 5th JULY 2023
9A	PHASE 9A - COMPLETE START DATE (ACTUAL): 12th JUNE 2023 END DATE (ACTUAL): 16th AUG 2023
9B	START DATE (ACTUAL): 03rd JAN 2024 END DATE (INDICATIVE): 16th APRIL 2024
10A	START DATE (ACTUAL): 19th OCT 2023 END DATE (INDICATIVE): 16th APRIL 2024
10B	PHASE 10B - COMPLETE START DATE (ACTUAL): 17th OCT 2023 END DATE (ACTUAL): 18th OCT 2023
10C	PHASE 10C - COMPLETE START DATE (ACTUAL): 25th SEPT 2023 END DATE (ACTUAL): 14th OCT 2023
10D	PHASE 10D - COMPLETE START DATE (ACTUAL): 10th OCT 2023 END DATE (ACTUAL): 16th OCT 2023
11	PHASE 11 - COMPLETE START DATE (ACTUAL): 26th JUNE 2023 END DATE (ACTUAL): 16th AUG 2023
12	START DATE (ACTUAL): 31st OCT 2023 END DATE (INDICATIVE): 15th MAR 2024
13	START DATE (INDICATIVE): TBC END DATE (INDICATIVE): TBC
14	START DATE (INDICATIVE): TBC END DATE (INDICATIVE): TBC
15A	PHASE 15A - COMPLETE START DATE (ACTUAL): 16th OCT 2023 END DATE (ACTUAL): 23rd OCT 2023
15B	PHASE 15B - COMPLETE START DATE (ACTUAL): 24th OCT 2023 END DATE (ACTUAL): 04th NOV 2023

S5-C15	29.02.2024	LI	MARCH UPDATE	PF	CDS
S5-C14	01.02.2024	LI	FEB UPDATE	PF	CDS
S5-C13	15.01.2024	LI	JAN UPDATE	PF	CDS
REV	DATE	BY	DESCRIPTION	CHK	APD

DRAWING STATUS

CONSULTATION



25 Mandela Way, London, SE1 5SZ
www.fmcconway.co.uk www.wsp.com

CLIENT



City of Westminster

PROJECT

**VILLIERS STREET
PUBLIC REALM SCHEME**

TITLE

**PHASING PLAN
SHEET 1 of 3**

SCALE @ A1	DATE	DESIGN/DRAWN	CHECKED	APPROVED	SHEET
1:200	29.02.2024	JR	MD	PF	A1
WSP PROJECT NO.	FMC PROJECT NO.	WCC PROJECT NO.			
XXXXX	WWESAXXXX	XXXXX			
DRAWING No.	REV				
70070290-WSP-P01-X-DR-HI-0004-01					S5-C15

This map is reproduced from Ordnance Survey material with the permission of Ordnance Survey on behalf of the Controller of Her Majesty's Stationery Office © Crown copyright. Unauthorised reproduction infringes Crown copyright and may lead to prosecution or civil proceedings. (WCC/LA 100019597)

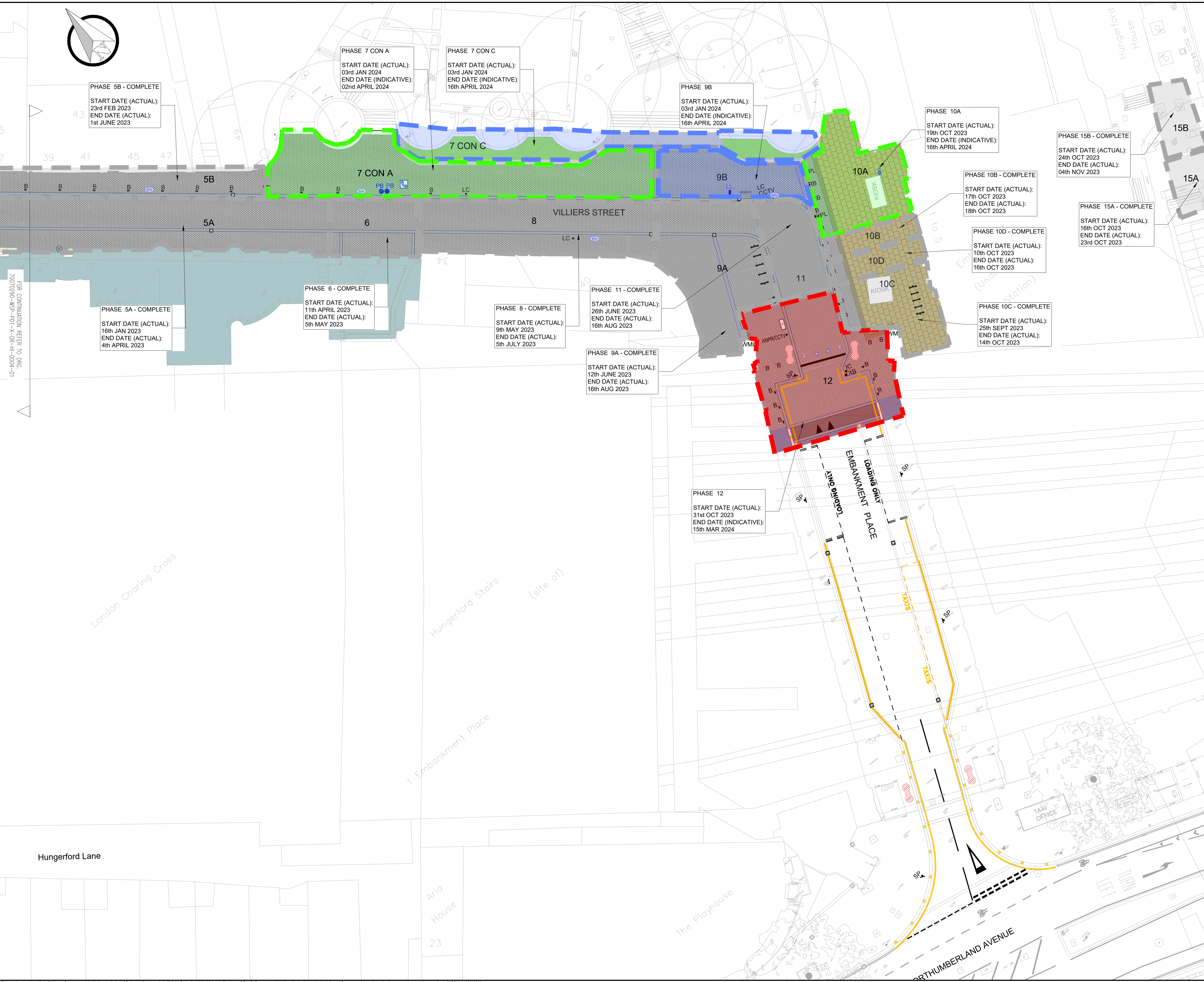

NOTES:
1. START AND END DATES OF PHASES SUBJECT TO CHANGE

KEY

1 HVM	PHASE 1 HVM - COMPLETE START DATE (ACTUAL): 09th JULY 2022 END DATE (ACTUAL): 19th AUG 2022
1A-1D	PHASE 1A TO 1D - COMPLETE START DATE (ACTUAL): 09th MAY 2022 END DATE (ACTUAL): 05th SEPT 2022
2	START DATE (ACTUAL): 22nd MARCH 2024 END DATE (INDICATIVE): TBC
3	PHASE 3 - COMPLETE START DATE (ACTUAL): 19th AUG 2022 END DATE (ACTUAL): 24th NOV 2022
4A	PHASE 4A - COMPLETE START DATE (ACTUAL): 19th AUG 2022 END DATE (ACTUAL): 14th FEB 2023
4B	PHASE 4B - COMPLETE START DATE (ACTUAL): 17th OCT 2022 END DATE (ACTUAL): 23rd FEB 2023
5A	PHASE 5A - COMPLETE START DATE (ACTUAL): 16th JAN 2023 END DATE (ACTUAL): 4th APRIL 2023
5B	PHASE 5B - COMPLETE START DATE (ACTUAL): 23rd FEB 2023 END DATE (ACTUAL): 1st JUNE 2023
6	PHASE 6 - COMPLETE START DATE (ACTUAL): 11th APRIL 2023 END DATE (ACTUAL): 5th MAY 2023
7 CON A	START DATE (ACTUAL): 03rd JAN 2024 END DATE (INDICATIVE): 02nd APRIL 2024
7 CON C	START DATE (ACTUAL): 03rd JAN 2024 END DATE (INDICATIVE): 16th APRIL 2024
8	PHASE 8 - COMPLETE START DATE (ACTUAL): 09th MAY 2023 END DATE (ACTUAL): 5th JULY 2023
9A	PHASE 9A - COMPLETE START DATE (ACTUAL): 12th JUNE 2023 END DATE (ACTUAL): 16th AUG 2023
9B	PHASE 9B - COMPLETE START DATE (ACTUAL): 03rd JAN 2024 END DATE (INDICATIVE): 16th APRIL 2024
10A	PHASE 10A - COMPLETE START DATE (ACTUAL): 19th OCT 2023 END DATE (INDICATIVE): 16th APRIL 2024
10B	PHASE 10B - COMPLETE START DATE (ACTUAL): 17th OCT 2023 END DATE (ACTUAL): 18th OCT 2023
10C	PHASE 10C - COMPLETE START DATE (ACTUAL): 25th SEPT 2023 END DATE (ACTUAL): 14th OCT 2023
10D	PHASE 10D - COMPLETE START DATE (ACTUAL): 10th OCT 2023 END DATE (ACTUAL): 16th OCT 2023
11	PHASE 11 - COMPLETE START DATE (ACTUAL): 26th JUNE 2023 END DATE (ACTUAL): 16th AUG 2023
12	PHASE 12 START DATE (ACTUAL): 31st OCT 2023 END DATE (INDICATIVE): 15th MAR 2024
13	START DATE (INDICATIVE): TBC END DATE (INDICATIVE): TBC
14	START DATE (INDICATIVE): TBC END DATE (INDICATIVE): TBC
15A	PHASE 15A - COMPLETE START DATE (ACTUAL): 24th OCT 2023 END DATE (ACTUAL): 04th NOV 2023
15B	PHASE 15B - COMPLETE START DATE (ACTUAL): 15th JAN 2024 END DATE (INDICATIVE): TBC

S5-C15	29.02.2024	LI	MARCH UPDATE	PF	CDS
S5-C14	01.02.2024	LI	FEB UPDATE	PF	CDS
S5-C13	15.01.2024	LI	JAN UPDATE	PF	CDS
REV	DATE	BY	DESCRIPTION	CHK	APD

DRAWING STATUS

CONSULTATION

25 Mandala Way, London, SE1 5SZ
www.fconway.co.uk www.wsp.com

CLIENT

City of Westminster

PROJECT

**VILLIERS STREET
PUBLIC REALM SCHEME**

TITLE

**PHASING PLAN
SHEET 2 of 3**

SCALE @ A1	DATE	DESIGN/DRAWN	CHECKED	APPROVED	SHEET
1:200	29.02.2024	JR	MD	PF	A1
WSP PROJECT NO.	FMC PROJECT NO.	WCC PROJECT NO.			
XXXXX	WWESAXXXX	XXXX			
DRAWING No.	REV				
70070290-WSP-P01-X-DR-HI-0004-02					

This map is reproduced from Ordnance Survey material with the permission of Ordnance Survey on behalf of the Controller of Her Majesty's Stationery Office © Crown copyright. Unauthorised reproduction infringes Crown copyright and may lead to prosecution or civil proceedings. (WCC/LA 100019597)